

THOMPSON

Middle School



STUDENT PLANNER

Semester 1
2024 - 2025

INSPIRING ALL STUDENTS TO THINK, LEARN, CARE, AND
ACHIEVE WITH P.R.I.D.E.

THOMPSON MIDDLE SCHOOL



24040 HAYES AVENUE
MURRIETA, CA 92562
(951) 696-1410

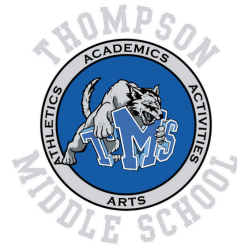

STUDENT INFORMATION

NAME:	
9 DIGIT ID:	
LOCKER #:	
SSID:	

BARCODE

THOMPSON MIDDLE SCHOOL

Schoolwide Expectations



SHOW **PRIDE** IN ALL THAT YOU DO!



- ASK FOR HELP WHEN NEEDED
- HAVE A POSITIVE ATTITUDE
- BE READY TO LEARN NEW THINGS
- COMPLETE ALL WORK



- USE KIND WORDS
- SHARE AND COOPERATE WITH OTHERS
- STOP, LISTEN, AND MAKE EYE CONTACT
- RESPECT SCHOOL RULES (NO GUM OR ELECTRONICS)



- BE AWARE OF YOUR SURROUNDINGS
- SEE SOMETHING, SAY SOMETHING
- TELL THE TRUTH
- COMPLETE AUTHENTIC WORK



- CHALLENGE YOURSELF
- DEDICATE YOUR TIME AND ENERGY APPROPRIATELY
- BE ON TIME
- BRING YOUR PLANNER EVERYDAY



- BE ACCOUNTABLE FOR YOUR ACTIONS
- ASK FOR HELP IF YOU NEED IT
- ALWAYS DO YOUR BEST

IN THE...
CLASSROOM

THOMPSON MIDDLE SCHOOL

House System



Here at Thompson Middle School, each student and staff member is a part of the house system. Students and staff find an immediate community and connection to our campus culture in being a part of a group. Students will spin for their house at the beginning of their journey at Thompson and will remain in their house for the duration of their time as a Timberwolf.

Each year the houses will compete for the “house cup.” Students can earn house points for participation in dress up days, events, intramurals, and demonstration of P.R.I.D.E. on campus. Throughout the year students will be rewarded for the points they have earned.

Visit student services to spin for your house if you have not yet! Let the competition begin!

180 Student Attendance Days (numbered 1-180)

M/F = High School Finals/Min. Day
M/C = Middle School Conferences

JUNE																														
1	2	3	4	5	6	7	8	9	10	11	12	13	14	15	16	17	18	19	20	21	22	23	24	25	26	27	28	29	30	
SS	A	B	F	F	F	SS	SS						SS	SS				H	H	SS	SS						SS	SS		
			ME	ME	ME																									
			2nd swim 6/5																											

Nighthawk Way

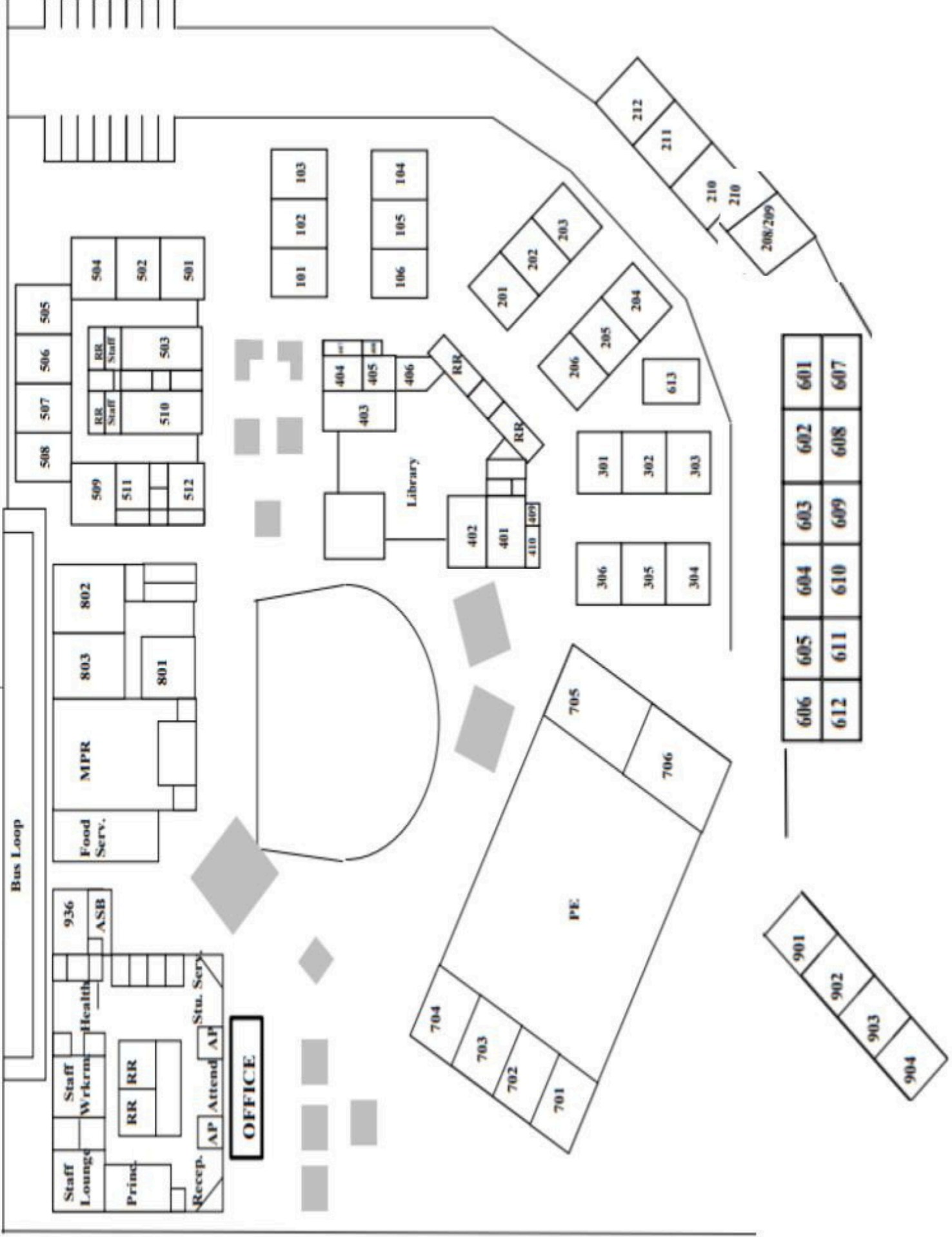

BELL SCHEDULE

REGULAR 1-6 Days - MONDAY and TUESDAY

6th and 1/2 of 7th Grade			8th and 1/2 of 7th Grade	
Period 0	7:50-8:35		Period 0	7:50-8:35
Period 1	8:50-9:45		Period 1	8:50-9:45
Period 2	9:49-10:38		1st Break	9:45-10:00
2nd Break	10:38-10:53		Period 2	10:04-10:53
Period 3	10:57-11:46		Period 3	10:57-11:46
Period 4	11:50-12:39		1st Lunch	11:46-12:16
2nd Lunch	12:39-1:09		Period 4	12:20-1:09
Period 5	1:13-2:02		Period 5	1:13-2:02
Period 6	2:06-2:55		Period 6	2:06-2:55

Early Out Day 1-6 - WEDNESDAY

6th and 1/2 of 7th Grade			8th and 1/2 of 7th Grade	
Period 0	7:50-8:35		Period 0	7:50-8:35
Period 1	8:50-9:30		Period 1	8:50-9:30
Period 2	9:34-10:10		1st Break	9:30-9:45
2nd Break	10:10-10:25		Period 2	9:49 -10:25
Period 3	10:29-11:05		Period 3	10:29-11:05
Period 4	11:09-11:45		1st Lunch	11:05-11:35
2nd Lunch	11:45-12:15		Period 4	11:39-12:15
Period 5	12:19-12:55		Period 5	12:19-12:55
Period 6	12:59-1:35		Period 6	12:59-1:35

Block Days with Office Hours - THURSDAY and FRIDAY

6th and 1/2 of 7th Grade			8th and 1/2 of 7th Grade	
Period 0	7:50-8:35		Period 0	7:50-8:35
Period 1/2	8:50-10:24		Period 1/2	8:50-9:36
2nd Break	10:24-10:39		1st Break	9:36-9:51
			Period 1/2	9:55-10:39
Office Hours	10:43-11:13		Office Hours	10:43-11:13
Period 3/4	11:17-12:52		Period 3/4	11:17-12:02
2nd Lunch	12:52-1:22		1st Lunch	12:02-12:32
			Period 3/4	12:36-1:22
Period 5/6	1:26-2:55		Period 5/6	1:26-2:55

BELL SCHEDULE

Early Out Day 1-6

6th and 1/2 of 7th Grade			8th and 1/2 of 7th Grade	
Period 0	7:50-8:35		Period 0	7:50-8:35
Period 1	8:50-9:30		Period 1	8:50-9:30
Period 2	9:34-10:10		1st Break	9:30-9:45
2nd Break	10:10-10:25		Period 2	9:49 -10:25
Period 3	10:29-11:05		Period 3	10:19-10:55
Period 4	11:09-11:45		1st Lunch	11:05-11:35
2nd Lunch	11:45-12:15		Period 4	11:39-12:15
Period 5	12:19-12:55		Period 5	12:19-12:55
Period 6	12:59-1:35		Period 6	12:59-1:35

Regular Day ASSEMBLY - Monday and Tuesday

6th and 1/2 of 7th Grade			8th and 1/2 of 7th Grade	
Period 0	7:50-8:35		Period 0	7:50-8:35
Assembly (PERIOD 1)	8:50-9:50		Assembly (PERIOD 1)	8:50-9:50
Period 1	9:50-10:30		Period 1	9:50-10:30
Period 2	10:34-11:14		1st Break	10:30-10:45
2nd Break	11:14-11:29		Period 2	10:49-11:29
Period 3	11:33-12:13		Period 3	11:33-12:13
Period 4	12:17-12:57		1st Lunch	12:13-12:43
2nd Lunch	12:57-1:27		Period 4	12:47-1:27
Period 5	1:31-2:11		Period 5	1:31-2:11
Period 6	2:15-2:55		Period 6	2:15-2:55

OFFICE HOURS

Priority Schedule

SEMESTER 1

WEEK	DATE	THURSDAY	FRIDAY
1	8/15-8/16	NO OH (1-6 DAYS)	
2	8/22-8/23	OH in Period 3 TMS Expectations	OH in Period 4 Office Hours Steps to Success
3	8/29-8/30	OH in Period 3 TMS House System	OH in Period 4 TMS House Gathering
4	9/5-9/6	ELA	SCIENCE
5	9/12-9/13	MATH	SS
6	9/19-9/20	SCIENCE	ELA
7	9/26-9/27	SS	MATH
8	10/3-10/4	ELA	SCIENCE
9	10/10-10/11	MATH	SS
10	10/17-10/18	SCIENCE	ELA
11	10/24-10/25	SS	MATH
12	10/31-11/1	NO OH	NON STUDENT DAY
13	11/7-11/8	ELA	SCIENCE
14	11/14-11/15	MATH	SS
15	11/21-11/22	NO OH (1-6 DAYS)	
	11/28-11/29	THANKSGIVING BREAK	
16	12/5-12-6	SCIENCE	ELA
17	12/12-12/13	SS	MATH
18	12/19-12-20	NO OH	

OFFICE HOURS STEPS TO SUCCESS

CHECK YOUR
GRADES &
PLANNER
DAILY

NO MISSING
ASSIGNMENTS
OR TESTS

KEEP YOUR
BINDER AND
BACKPACK
ORGANIZED

HOW CAN I PLAN TO BE SUCCESSFUL DURING OFFICE HOURS?

Step 1

**TAKE OUT YOUR PLANNER AND BE READY TO
CHECK IN BEFORE GETTING TO OFFICE HOURS**

Step 2

CHECK YOUR PLANNER

- Check for teacher stamps
- Attend priority sessions, if stamped

**CHECK GRADES ON AERIES
OR CANVAS**

Step 3

HAVE A BACKUP PLAN

- If you do not have any stamps, attend sessions in classes with your lowest grades
- Attend enrichment sessions if available

Student Notes



August 2024

SUN	MON	TUE	WED	THU	FRI	SAT
				1	2	3
4	5	6	7	8	9	10
11	12	13	14	15	16	17
18	19	20	21	22	23	24
25	26	27	28	29	30	31

WEEK

1

AUGUST
12-16

Office Hours Priority
THUR: NONE
FRI: NONE

12

MONDAY

13

TUESDAY

14

WEDNESDAY
EO 1-6

MATH

SCIENCE

ELA

SS

ELECTIVE

NOTES

OFFICE HOURS PROTOCOL

Stamps: Attend priority class(es) if you are stamped; then other stamped classes

NO Stamps: Attend open sesions or enrichment

	15	THURSDAY REG 1-6	OH: NONE	16	FRIDAY REG 1-6	OH: NONE
MATH						
SCIENCE						
ELA						
SS						
ELECTIVE						
NOTES						

WEEK

2

AUGUST

19-23

Office Hours Priority

THUR: NONE

FRI: NONE

19

MONDAY
REG 1-6

20

TUESDAY
REG 1-6

21

WEDNESDAY
EO 1-6

MATH

SCIENCE

ELA

SS

ELECTIVE

NOTES

OFFICE HOURS PROTOCOL

Stamps: Attend priority class(es) if you are stamped; then other stamped classes

NO Stamps: Attend open sesions or enrichment

	22	THURSDAY BLOCK 1,3,5	OH: NONE	23	FRIDAY BLOCK 2,4,6	OH: NONE
MATH						
SCIENCE						
ELA						
SS						
ELECTIVE						
NOTES						

WEEK

3

AUGUST
26-30

Office Hours Priority
THUR: **NONE**
FRI: **NONE**

26

MONDAY
REG 1-6

27

TUESDAY
REG 1-6

28

WEDNESDAY
EO 1-6

MATH

SCIENCE

ELA

SS

ELECTIVE

NOTES

OFFICE HOURS PROTOCOL

Stamps: Attend priority class(es) if you are stamped; then other stamped classes

NO Stamps: Attend open sesions or enrichment

	29THURSDAY BLOCK 1,3,5	OH: NONE	30FRIDAY BLOCK 2,4,6	OH: NONE
MATH				
SCIENCE				
ELA				
SS				
ELECTIVE				
NOTES				

Student Notes



September 2024

SUN	MON	TUE	WED	THU	FRI	SAT
1	2	3	4	5	6	7
8	9	10	11	12	13	14
15	16	17	18	19	20	21
22	23	24	25	26	27	28
29	30					

WEEK

4

SEPTEMBER

2-6

Office Hours Priority

THUR: ELA

FRI: SCIENCE

2

MONDAY
NO SCHOOL

3

TUESDAY
REG 1-6

4

WEDNESDAY
EO 1-6

MATH

SCIENCE

ELA

SS

ELECTIVE

NOTES

OFFICE HOURS PROTOCOL

Stamps: Attend priority class(es) if you are stamped; then other stamped classes

NO Stamps: Attend open sesions or enrichment

	5	THURSDAY BLOCK 1,3,5	OH: ELA	6	FRIDAY BLOCK 2,4,6	OH: SCI
MATH						
SCIENCE						
ELA						
SS						
ELECTIVE						
NOTES						

WEEK

5

SEPTEMBER

9-13

Office Hours Priority

THUR: MATH

FRI: SS

9

MONDAY
REG 1-6

10

TUESDAY
REG 1-6

11

WEDNESDAY
EO 1-6

MATH

SCIENCE

ELA

SS

ELECTIVE

NOTES

OFFICE HOURS PROTOCOL

Stamps: Attend priority class(es) if you are stamped; then other stamped classes

NO Stamps: Attend open sesions or enrichment

	12THURSDAY BLOCK 1,3,5	OH: MATH	13FRIDAY BLOCK 2,4,6	OH: SS
MATH				
SCIENCE				
ELA				
SS				
ELECTIVE				
NOTES				

WEEK

6

SEPTEMBER

16-20

Office Hours Priority

THUR: SCIENCE

FRI: ELA

16

MONDAY
REG 1-6

17

TUESDAY
REG 1-6

18

WEDNESDAY
EO 1-6

MATH

SCIENCE

ELA

SS

ELECTIVE

NOTES

OFFICE HOURS PROTOCOL

Stamps: Attend priority class(es) if you are stamped; then other stamped classes

NO Stamps: Attend open sesions or enrichment

	19THURSDAY BLOCK 1,3,5	OH: SCI	20FRIDAY BLOCK 2,4,6	OH: ELA
MATH				
SCIENCE				
ELA				
SS				
ELECTIVE				
NOTES				

WEEK

7

SEPTEMBER

23-27

Office Hours Priority

THUR: SS

FRI: MATH

23

MONDAY
REG 1-6

24

TUESDAY
REG 1-6

25

WEDNESDAY
EO 1-6

MATH

SCIENCE

ELA

SS

ELECTIVE

NOTES

OFFICE HOURS PROTOCOL

Stamps: Attend priority class(es) if you are stamped; then other stamped classes

NO Stamps: Attend open sesions or enrichment

	26	THURSDAY BLOCK 1,3,5	OH: SS	27	FRIDAY BLOCK 2,4,6	OH: MATH
MATH						
SCIENCE						
ELA						
SS						
ELECTIVE						
NOTES						

Student Notes



October

2024

SUN	MON	TUE	WED	THU	FRI	SAT
		1	2	3	4	5
6	7	8	9	10	11	12
13	14	15	16	17	18	19
20	21	22	23	24	25	26
27	28	29	30	31		

WEEK

8

SEP-OCT

30-4

Office Hours Priority

THUR: ELA

FRI: SCIENCE

30

MONDAY
REG 1-6

1

TUESDAY
REG 1-6

2

WEDNESDAY
EO 1-6

MATH

SCIENCE

ELA

SS

ELECTIVE

NOTES

OFFICE HOURS PROTOCOL

Stamps: Attend priority class(es) if you are stamped; then other stamped classes

NO Stamps: Attend open sesions or enrichment

	3	THURSDAY BLOCK 1,3,5	OH: ELA	4	FRIDAY BLOCK 2,4,6	OH: SCI
MATH						
SCIENCE						
ELA						
SS						
ELECTIVE						
NOTES						

WEEK

9

OCTOBER

7-11

Office Hours Priority

THUR: MATH

FRI: SS

7

MONDAY
REG 1-6

8

TUESDAY
REG 1-6

9

WEDNESDAY
EO 1-6

MATH

SCIENCE

ELA

SS

ELECTIVE

NOTES

OFFICE HOURS PROTOCOL

Stamps: Attend priority class(es) if you are stamped; then other stamped classes

NO Stamps: Attend open sesions or enrichment

	10 THURSDAY BLOCK 1,3,5	OH: MATH	11 FRIDAY BLOCK 2,4,6	OH: SS
MATH				
SCIENCE				
ELA				
SS				
ELECTIVE				
NOTES				

WEEK

10 OCTOBER
14-18

Office Hours Priority
THUR: SCIENCE
FRI: ELA

14

MONDAY
REG 1-6

15

TUESDAY
REG 1-6

16

WEDNESDAY
EO 1-6

MATH

SCIENCE

ELA

SS

ELECTIVE

NOTES

OFFICE HOURS PROTOCOL

Stamps: Attend priority class(es) if you are stamped; then other stamped classes

NO Stamps: Attend open sesions or enrichment

	17THURSDAY BLOCK 1,3,5	OH: SCI	18FRIDAY BLOCK 2,4,6	OH: ELA
MATH				
SCIENCE				
ELA				
SS				
ELECTIVE				
NOTES				

WEEK

11 **OCTOBER**
21-25

Office Hours Priority
THUR: SS
FRI: MATH

21

MONDAY
REG 1-6

22

TUESDAY
REG 1-6

23

WEDNESDAY
EO 1-6

MATH

SCIENCE

ELA

SS

ELECTIVE

NOTES

OFFICE HOURS PROTOCOL

Stamps: Attend priority class(es) if you are stamped; then other stamped classes

NO Stamps: Attend open sesions or enrichment

	24THURSDAY BLOCK 1,3,5	OH: SS	25FRIDAY BLOCK 2,4,6	OH: MATH
MATH				
SCIENCE				
ELA				
SS				
ELECTIVE				
NOTES				

WEEK

12 OCT - NOV
28-1

Office Hours Priority
THUR: NONE
FRI: NONE

28

MONDAY
REG 1-6

29

TUESDAY
REG 1-6

30

WEDNESDAY
EO 1-6

MATH

SCIENCE

ELA

SS

ELECTIVE

NOTES

OFFICE HOURS PROTOCOL

Stamps: Attend priority class(es) if you are stamped; then other stamped classes

NO Stamps: Attend open sesions or enrichment

	31THURSDAY REG 1-6	OH: NONE	1FRIDAY	OH: NONE
MATH			NON STUDENT DAY	
SCIENCE				
ELA				
SS				
ELECTIVE				
NOTES				

Student Notes



2024
November

SUN	MON	TUE	WED	THU	FRI	SAT
					1	2
3	4	5	6	7	8	9
10	11	12	13	14	15	16
17	18	19	20	21	22	23
24	25	26	27	28	29	30

WEEK

13

NOVEMBER

4-8

Office Hours Priority

THUR: ELA

FRI: SCIENCE

4

MONDAY
REG 1-6

5

TUESDAY
REG 1-6

6

WEDNESDAY
EO 1-6

MATH

SCIENCE

ELA

SS

ELECTIVE

NOTES

OFFICE HOURS PROTOCOL

Stamps: Attend priority class(es) if you are stamped; then other stamped classes

NO Stamps: Attend open sesions or enrichment

	7	THURSDAY REG 1-6	OH: ELA	8	FRIDAY BLOCK 2,4,6	OH: SCI
MATH						
SCIENCE						
ELA						
SS						
ELECTIVE						
NOTES						

WEEK

14

NOVEMBER

11-15

Office Hours Priority

THUR: MATH

FRI: SS

11

MONDAY
NO SCHOOL

12

TUESDAY
REG 1-6

13

WEDNESDAY
EO 1-6

MATH

SCIENCE

ELA

SS

ELECTIVE

NOTES

OFFICE HOURS PROTOCOL

Stamps: Attend priority class(es) if you are stamped; then other stamped classes

NO Stamps: Attend open sesions or enrichment

	14THURSDAY REG 1-6	OH: MATH	15FRIDAY BLOCK 2,4,6	OH: SS
MATH				
SCIENCE				
ELA				
SS				
ELECTIVE				
NOTES				

WEEK

15 NOVEMBER
18-22

Office Hours Priority
THUR: NONE
FRI: NONE

18

MONDAY
REG 1-6

19

TUESDAY
REG 1-6

20

WEDNESDAY
EO 1-6

MATH

SCIENCE

ELA

SS

ELECTIVE

NOTES

OFFICE HOURS PROTOCOL

Stamps: Attend priority class(es) if you are stamped; then other stamped classes

NO Stamps: Attend open sesions or enrichment

	21	THURSDAY REG 1-6	OH: NONE	22	FRIDAY REG 1-6	OH: NONE
MATH						
SCIENCE						
ELA						
SS						
ELECTIVE						
NOTES						

WEEK

THANKS
GIVING
BREAK

NOVEMBER

25-29

Office Hours Priority

THUR: NONE

FRI: NONE

25

MONDAY

26

TUESDAY

27

WEDNESDAY

MATH

SCIENCE

ELA

SS

ELECTIVE

NOTES

OFFICE HOURS PROTOCOL

Stamps: Attend priority class(es) if you are stamped; then other stamped classes

NO Stamps: Attend open sesions or enrichment

	28THURSDAY	OH: NONE	29FRIDAY	OH: NONE
MATH				
SCIENCE				
ELA				
SS				
ELECTIVE				
NOTES				

Student Notes



December

2024

SUN	MON	TUE	WED	THU	FRI	SAT
1	2	3	4	5	6	7
8	9	10	11	12	13	14
15	16	17	18	19	20	21
22	23	24	25	26	27	28
29	30	31				

WEEK

16

DECEMBER

2-6

Office Hours Priority

THUR: SCIENCE

FRI: ELA

2

MONDAY
REG 1-6

3

TUESDAY
REG 1-6

4

WEDNESDAY
EO 1-6

MATH

SCIENCE

ELA

SS

ELECTIVE

NOTES

OFFICE HOURS PROTOCOL

Stamps: Attend priority class(es) if you are stamped; then other stamped classes

NO Stamps: Attend open sesions or enrichment

	5	THURSDAY BLOCK 1,3,5	OH: SCI	6	FRIDAY BLOCK 2,4,6	OH: ELA
MATH						
SCIENCE						
ELA						
SS						
ELECTIVE						
NOTES						

WEEK

17

DECEMBER

9-13

Office Hours Priority

THUR: SS

FRI: MATH

9

MONDAY
REG 1-6

10

TUESDAY
REG 1-6

11

WEDNESDAY
EO 1-6

MATH

SCIENCE

ELA

SS

ELECTIVE

NOTES

OFFICE HOURS PROTOCOL

Stamps: Attend priority class(es) if you are stamped; then other stamped classes

NO Stamps: Attend open sesions or enrichment

	12	THURSDAY BLOCK 1,3,5	OH: SS	13	FRIDAY BLOCK 2,4,6	OH: MATH
MATH						
SCIENCE						
ELA						
SS						
ELECTIVE						
NOTES						

WEEK

18 **DECEMBER**
16-20

Office Hours Priority
THUR: NONE
FRI: NONE

16

MONDAY
REG 1-6

17

TUESDAY
REG 1-6

18

WEDNESDAY
REG 1-6

MATH

SCIENCE

ELA

SS

ELECTIVE

NOTES

OFFICE HOURS PROTOCOL

Stamps: Attend priority class(es) if you are stamped; then other stamped classes

NO Stamps: Attend open sesions or enrichment

	19THURSDAY EO BLOCK 2-4-6	OH: NONE	20FRIDAY EO 1-6	OH: NONE
MATH				
SCIENCE				
ELA				
SS				
ELECTIVE				
NOTES				