





COLOR PALETTE:



MANUFACTURERS:



PROJECT:

FAMILY SERVICES - TODDLER AREA

MURRIETA, CA - OPTION 2

DESIGNED BY:  
JONATHAN BOURBONNAIS  
DECEMBER 30, 2024  
DRAWING # C24419CHR1  
PROJECT # 24006303

DESIGNED FOR:

AGES  
2-5

since 1979  
dave bang  
associates inc.  
▶ park+playground outfitters







COLOR PALETTE:



MANUFACTURERS:



PROJECT:

FAMILY SERVICES - TODDLER AREA

MURRIETA, CA - OPTION 2

DESIGNED BY:

JONATHAN BOURBONNAIS

DECEMBER 30, 2024

DRAWING # C24419CHR1

PROJECT # 24006303

DESIGNED FOR:

AGES

2-5

since 1979

dave bang

associates inc.

park+playground outfitters







COLOR PALETTE:



MANUFACTURERS:



PROJECT:

# FAMILY SERVICES - TODDLER AREA

MURRIETA, CA - OPTION 2

DESIGNED BY:

JONATHAN BOURBONNAIS  
DECEMBER 30, 2024  
DRAWING # C24419CHR1  
PROJECT # 24006303

DESIGNED FOR:

AGES  
2-5

since 1979  
**dave bang**  
associates inc.  
▶ park+playground outfitters







COLOR PALETTE:

MANUFACTURERS:



PROJECT:

FAMILY SERVICES - TODDLER AREA

MURRIETA, CA - OPTION 2

DESIGNED BY:

JONATHAN BOURBONNAIS

DECEMBER 30, 2024

DRAWING # C24419CHR1

PROJECT # 24006303

DESIGNED FOR:

AGES

2-5

since 1979

dave bang

associates inc.

park+playground outfitters







SELECTED COLORS

POST: BEIGE

COMPONENT 1: N/A

COMPONENT 2: N/A

ROTOMOLDED PLASTIC 1: BEIGE

ROTOMOLDED PLASTIC 2: N/A

ROTOMOLDED PLASTIC 3: N/A

SHEET PLASTIC 1: DARK BROWN

SHEET PLASTIC 2: LIME

2-TONE PLASTIC: DARK BROWN/SAND

ROPE: N/A

ECO-ARMOR: N/A

MODIFIED COLORS LISTED BELOW

COLOR PALETTE:

MANUFACTURERS:

Percussion  
Play

PLAYWORLD

cre8play

PROJECT:

FAMILY SERVICES - TODDLER AREA

MURRIETA, CA - OPTION 2

DESIGNED BY:

JONATHAN BOURBONNAIS

DECEMBER 30, 2024

DRAWING # C24419CHR1

PROJECT # 24006303

DESIGNED FOR:

AGES

2-5

since 1979

dave bang

associates inc.

park+playground outfitters





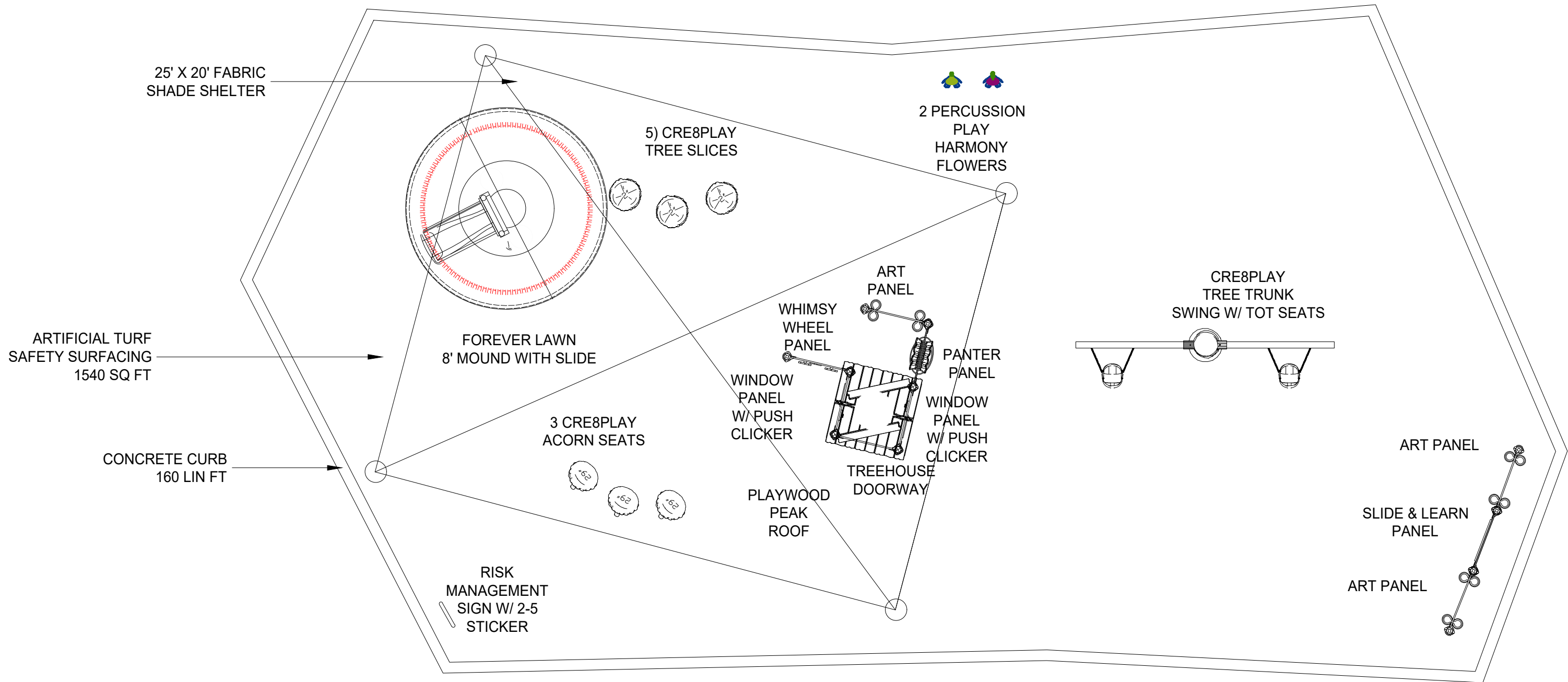

PLAY STRUCTURE AND LAYOUT OF THE COMPONENTS CONFORM TO  
ASTM F1487-21 AND CPSC #325 GUIDELINES AND CCR TITLE 22,  
DIVISION 4 CHAPTER 22.  
CRITICAL FALL HEIGHT OF OVERALL PLAY AREA: 84"

PROJECT

## FAMILY SERVICES - TODDLER AREA

MURRIETA, CA - OPTION 2

DESIGNED BY:

JONATHAN BOURBONNAIS

DECEMBER 23, 2024

DRAWING # **C24419CHR1**

PROJECT # **24006303**

DESIGNED FOR

AGES  
**2-5**

since 1979  
**dave bang**  
associates inc.  
park+playground outfitters

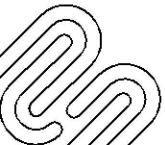



# Family Services

Design Number: C24419CHR1 - Bill Of Material

Ref. No.	Part No.	Description	Quantity
<b>Posts</b>			
1	ZZCH0207	3.5in OD x 108in SWAGED STEEL POST	4
2	ZZCH0356	3.50in x 88in STEEL POST w/CAP	7
<b>Activity Panels</b>			
3	ZZCH4379	ART PANEL (GROUND LEVEL)	3
4	ZZCH4447	SLIDE-N-LEARN PANEL (GROUND LEVEL)	1
5	ZZCH4527	WINDOW PANEL W/ PUSH CLICKER (GROUND LEVEL)	2
6	ZZCH4529	WHIMSY WHEEL PANEL (GROUND LEVEL)	1
7	ZZCH4626	WINDOW PLANTER PANEL	1
8	ZZCH4639	TREE HOUSE DOORWAY (GROUND LEVEL)	1
<b>Roofs &amp; Arches</b>			
9	ZZCH9606	PLAYWOOD SINGLE PEAK ROOF	1





## Family Services

Design Number: C24419CHR1 - Compliance and Technical Data

Reference Document: ASTM F1487

Ref. No.	Part No.	Qty.	Description	Unit ASTM Status	Total Weight (lbs)	Pre- Consumer Recycled Content (lbs)	Post- Consumer Content (lbs)	CO2e Footprint (kgs)	Users	Install Hours	Concrete (Yds3)	Active Play Events
1	ZZCH0207	4	3.5in OD x 108in SWAGED STEEL POST	Certified	141.64			178	0	2.00	0.50	0
2	ZZCH0356	7	3.50in x 88in STEEL POST w/CAP	Certified	207.97			277	0	7.00	0.91	0
3	ZZCH4379	3	ART PANEL (GROUND LEVEL)	Certified	62.70			752	0	3.00	0.00	0
4	ZZCH4447	1	SLIDE-N-LEARN PANEL (GROUND LEVEL)	Certified	57.88			539	1	1.00	0.00	1
5	ZZCH4527	2	WINDOW PANEL W/ PUSH CLICKER (GROUND LEVEL)	Certified	65.30			463	4	2.00	0.00	2
6	ZZCH4529	1	WHIMSY WHEEL PANEL (GROUND LEVEL)	Certified	31.10			271	2	1.00	0.00	1
7	ZZCH4626	1	WINDOW PLANTER PANEL	Certified	42.83			387	2	0.50	0.00	1
8	ZZCH4639	1	TREE HOUSE DOORWAY (GROUND LEVEL)	Certified	22.42			283	2	0.50	0.00	1
9	ZZCH9606	1	PLAYWOOD SINGLE PEAK ROOF	Certified	183.19			214	0	3.00	0.00	0
<b>Totals:</b>					<b>815.03</b>	<b>233</b>	<b>226</b>	<b>3,363</b>	<b>11</b>	<b>20.00</b>	<b>1.41</b>	<b>6</b>
					<b>0 Kg</b>	<b>0 Kg</b>	<b>0 Kg</b>	<b>0 Metric Tons</b>	<b>0 m3</b>			





# Family Services

Design Number: C24419CHR1 - Compliance and Technical Data

Reference Document: ASTM F1487

Ref.	Unit	Total	Pre-	Post-	CO2e		Install	Concrete	Active
No.	ASTM	Weight	Consumer	Consumer	Footprint	Users	Hours	(Yds3)	Play
Part No.	Status	(lbs)	Recycled	Content	(kgs)				Events
Qty.	Description								

## ASTM F1487

The lay-out for this custom playscape, design number C24419CHR1, has been configured to meet the requirements of the ASTM F1487 standard. In addition, each of the above components listed as "Certified" have been tested and are IPEMA certified. Components listed as "Not Applicable" do not fall within the scope of the ASTM F1487 standard and have not been tested. IPEMA certification can be verified on the IPEMA website, [www.ipema.org](http://www.ipema.org). In the interest of playground safety, IPEMA provides a Third Party Certification Service which validates compliance.

## 2010 ADA Standards for Accessible Design

The lay-out was also designed to meet the 2010 Standards published 15-Sep-2010, by the Department of Justice when installed over a properly maintained surfacing material that is in compliance with ASTM F1951 "Accessibility of Surface Systems Under and Around Playground Equipment" as well as ASTM F1292, "Impact Attenuation of Surfacing Materials Within the Use Zone of Playground Equipment", appropriate for the fall height of the structure.

## Installation Times

Installation times are based on one experienced installer. A crew of three experienced individuals can perform the installation within the given time, each member working 1/3 of the given hours. [Eg. Installation Time = 30 hours. For a crew of three, each member will work 10 hours on the installation for a total of 30 hours on the project.]

## Carbon Footprint

The CO2e (carbon footprint given in Kilograms and Metric Tons) listed above is a measure of the environmental impact this play structure represents from harvesting raw materials to the time it leaves our shipping dock. Playworld Systems nurtures a total corporate culture that is focused on eliminating carbon producing processes and products, reducing our use of precious raw materials, reusing materials whenever possible and recycling materials at every opportunity. Playworld Systems elected to adopt the Publicly Available Specification; PAS 2050 as published by the British Standards Institute and sponsored by Defra and the Carbon Trust. The PAS 2050 has gained international acceptance as a specification that measures the greenhouse gas emissions in services and goods throughout their entire life cycle.

## Pre-Consumer Recycle Content

A measurement, in pounds, that qualifies the amount of material that was captured as waste and diverted from landfill during an initial manufacturing process and is being redirected to a separate manufacturing process to become a different product. E.g. 100% of our Aluminum Tubing is made from captured waste material during the manufacturing process of extruded Aluminum products such as rods, flat bars and H-channels.

## Post-Consumer Recycle Content

A measurement, in pounds, that qualifies the amount of material that was once another product that has completed its lifecycle and has been diverted from a landfill as a solid waste through recycling and is now being used in a Playworld Systems' product. E.g. \*\*20% to 40% of the steel in our steel tubing and sheet steel have been diverted from landfills. Automobiles are scrapped and recyclable steel is purchased by the steel mill that produces our raw product.

\*\* The amount of Post-Consumer recycled steel fluctuates daily based on the availability of the recycled steel.







COLOR PALETTE:

MANUFACTURERS:

PROJECT:

FAMILY SERVICES - 2-5 AREA WEST

MURRIETA, CA

DESIGNED BY:

JONATHAN BOURBONNAIS

DECEMBER 30, 2024

DRAWING# C24421CHR1

PROJECT# 24006303

DESIGNED FOR:

AGES

2-5

since 1979

dave bang

associates inc.

park+playground outfitters







COLOR PALETTE:

MANUFACTURERS:

PROJECT:

FAMILY SERVICES - 2-5 AREA WEST

MURRIETA, CA

DESIGNED BY:

JONATHAN BOURBONNAIS

DECEMBER 30, 2024

DRAWING# C24421CHR1

PROJECT# 24006303

DESIGNED FOR:

AGES

2-5

since 1979

dave bang

associates inc.

park+playground outfitters







COLOR PALETTE:



MANUFACTURERS:



PROJECT:

FAMILY SERVICES - 2-5 AREA WEST  
MURRIETA, CA

DESIGNED BY:

JONATHAN BOURBONNAIS  
DECEMBER 30, 2024  
DRAWING# C24421CHR1  
PROJECT# 24006303

DESIGNED FOR:

AGES  
2-5

since 1979  
**dave bang**  
associates inc.  
park+playground outfitters







COLOR PALETTE:



MANUFACTURERS:



PROJECT:

FAMILY SERVICES - 2-5 AREA WEST  
MURRIETA, CA

DESIGNED BY:

JONATHAN BOURBONNAIS  
DECEMBER 30, 2024  
DRAWING# C24421CHR1  
PROJECT# 24006303

DESIGNED FOR:

AGES  
2-5

since 1979  
**dave bang**  
associates inc.  
▶ park+playground outfitters







## SELECTED COLORS

POST: SAND

COMPONENT 1: FOREST GREEN

COMPONENT 2: N/A

ROTOMOLDED PLASTIC 1: LIME

ROTOMOLDED PLASTIC 2: N/A

ROTOMOLDED PLASTIC 3: N/A

SHEET PLASTIC 1: DARK BROWN

SHEET PLASTIC 2: N/A

2-TONE PLASTIC: DARK BROWN/SAND

ROPE: N/A

ECO-ARMOR: BROWN

## MODIFIED COLORS LISTED BELOW

ROCK CLIMBER: BROWNSTONE

COLOR PALETTE:



MANUFACTURERS:



PROJECT:

FAMILY SERVICES - 2-5 AREA WEST  
MURRIETA, CA

DESIGNED BY:

JONATHAN BOURBONNAIS  
DECEMBER 30, 2024  
DRAWING# C24421CHR1  
PROJECT# 24006303

DESIGNED FOR:

AGES  
2-5

since 1979  
**dave bang**  
associates inc.  
park+playground outfitters





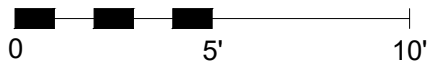
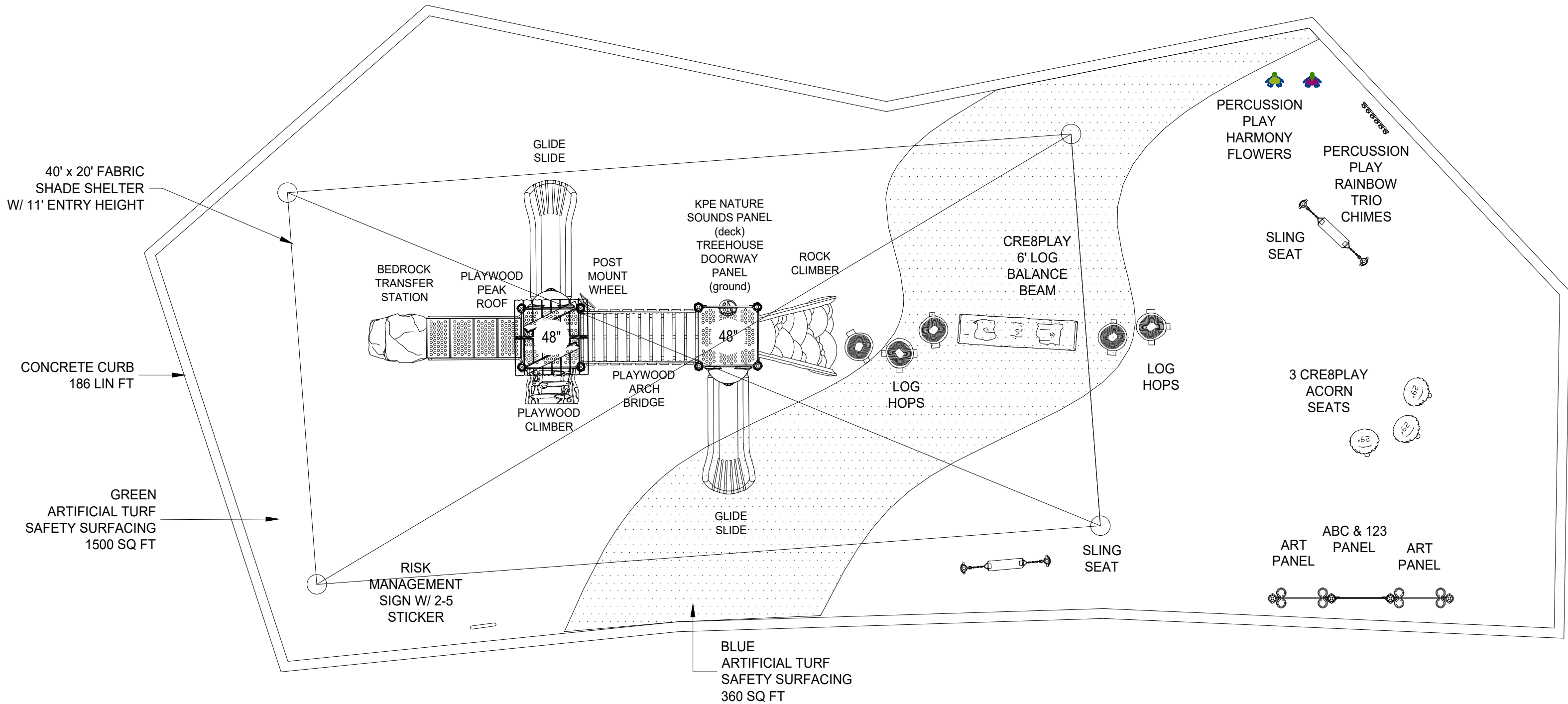

TOTAL ELEVATED PLAY COMPONENTS:	6	
TOTAL ELEVATED PLAY COMPONENTS ACCESSIBLE BY RAMP:	0	REQUIRED: 0
TOTAL ELEVATED PLAY COMPONENTS ACCESSIBLE BY TRANSFER:	5	REQUIRED: 3
TOTAL ACCESSIBLE GROUND LEVEL COMPONENTS SHOWN:	19	REQUIRED: 2
TOTAL ACCESSIBLE GROUND LEVEL COMPONENTS OF DIFFERENT TYPES:	7	REQUIRED: 2

\* APPLICABLE ONLY WITH ADA COMPLIANT SURFACING.



# Family Services

Design Number: C24421CHR1 - Bill Of Material

Ref. No.	Part No.	Description	Quantity
<b>Posts</b>			
1	ZZCH0028	3.5in OD x 136in STEEL POST W/ RIVETED CAP	4
2	ZZCH0217	3.5in OD x 156in SWAGED STEEL POST	4
3	ZZCH0356	3.50in x 88in STEEL POST w/CAP	8
<b>Decks &amp; Kick Plates</b>			
4	ZZCH0616	SQUARE COATED DECK ASSEMBLY	2
<b>Slides</b>			
5	ZZCH3126	GLIDE SLIDE (48in DECK)	2
<b>Activity Panels</b>			
6	ZZCH4290	POST MOUNTED STEERING WHEEL	1
7	ZZCH4298	ABC & 123 PANEL (GROUND LEVEL)	1
8	ZZCH4379	ART PANEL (GROUND LEVEL)	2
9	ZZCH4636	NATURE SOUNDS PANEL	1
10	ZZCH4639	TREE HOUSE DOORWAY (GROUND LEVEL)	1
11	ZZCH4896	SLING SEAT	2
<b>Climbers</b>			
12	ZZCH6816	TREE HOUSE CLIMBER (48in DECK)	1
<b>Bridges</b>			
13	ZZCH6958	6ft PLAYWOOD ARCH BRIDGE	1
<b>Climbers</b>			
14	ZZCH7439	ROCK CLIMBER (48in DECK)	1
<b>ADA Items</b>			
15	ZZCH8819	BEDROCK TRANSFER- 48in BARRIER	1
<b>Roofs &amp; Arches</b>			
16	ZZCH9606	PLAYWOOD SINGLE PEAK ROOF	1
<b>Climbers</b>			
17	ZZUN8396	12in LOG HOP	3
18	ZZUN8428	16in LOG HOP	2



## Family Services

Design Number: C24421CHR1 - Compliance and Technical Data

Reference Document: ASTM F1487

Ref. No.	Part No.	Qty.	Description	Unit ASTM Status	Total Weight (lbs)	Pre- Consumer Recycled Content (lbs)	Post- Consumer Content (lbs)	CO2e Footprint (kgs)	Users	Install Hours	Concrete (Yds3)	Active Play Events
1	ZZCH0028	4	3.5in OD x 136in STEEL POST W/ RIVETED CAP	Certified	174.04			234	0	4.00	0.50	0
2	ZZCH0217	4	3.5in OD x 156in SWAGED STEEL POST	Certified	315.24			254	0	2.00	0.50	0
3	ZZCH0356	8	3.50in x 88in STEEL POST w/CAP	Certified	237.68			316	0	8.00	1.04	0
4	ZZCH0616	2	SQUARE COATED DECK ASSEMBLY	Certified	109.72			348	6	2.00	0.00	0
5	ZZCH3126	2	GLIDE SLIDE (48in DECK)	Certified	239.46			983	4	3.00	0.06	2
6	ZZCH4290	1	POST MOUNTED STEERING WHEEL	Certified	7.83			44	1	0.25	0.00	1
7	ZZCH4298	1	ABC & 123 PANEL (GROUND LEVEL)	Certified	35.94			289	1	0.50	0.00	1
8	ZZCH4379	2	ART PANEL (GROUND LEVEL)	Certified	41.80			501	0	2.00	0.00	0
9	ZZCH4636	1	NATURE SOUNDS PANEL	Certified	30.31			985	2	0.50	0.00	1
10	ZZCH4639	1	TREE HOUSE DOORWAY (GROUND LEVEL)	Certified	22.42			283	2	0.50	0.00	1
11	ZZCH4896	2	SLING SEAT	Certified	25.00			293	2	1.00	0.00	2
12	ZZCH6816	1	TREE HOUSE CLIMBER (48in DECK)	Certified	96.24			636	2	2.00	0.06	1
13	ZZCH6958	1	6ft PLAYWOOD ARCH BRIDGE	Certified	327.89			434	3	2.50	0.00	1
14	ZZCH7439	1	ROCK CLIMBER (48in DECK)	Certified	136.38			555	3	2.00	0.03	1
15	ZZCH8819	1	BEDROCK TRANSFER- 48in BARRIER	Certified	916.33			2,889	3	3.50	0.22	1
16	ZZCH9606	1	PLAYWOOD SINGLE PEAK ROOF	Certified	183.19			214	0	3.00	0.00	0
17	ZZUN8396	3	12in LOG HOP	Certified	152.91			323	3	3.00	0.09	3
18	ZZUN8428	2	16in LOG HOP	Certified	107.88			233	2	2.00	0.06	2
<b>Totals:</b>					<b>3,160.26</b>	<b>389</b>	<b>519</b>	<b>9,813</b>	<b>34</b>	<b>41.75</b>	<b>2.56</b>	<b>17</b>
					<b>0 Kg</b>	<b>0 Kg</b>	<b>0 Kg</b>	<b>0 Metric Tons</b>	<b>0 m3</b>			





# Family Services

Design Number: C24421CHR1 - Compliance and Technical Data

Reference Document: ASTM F1487

Ref.	Unit	Total	Pre-	Post-	CO2e		Install	Concrete	Active
No.	ASTM	Weight	Consumer	Consumer	Footprint	Users	Hours	(Yds3)	Play
Part No.	Status	(lbs)	Recycled	Content	(kgs)				Events
Qty.	Description								

## ASTM F1487

The lay-out for this custom playscape, design number C24421CHR1, has been configured to meet the requirements of the ASTM F1487 standard. In addition, each of the above components listed as "Certified" have been tested and are IPEMA certified. Components listed as "Not Applicable" do not fall within the scope of the ASTM F1487 standard and have not been tested. IPEMA certification can be verified on the IPEMA website, [www.ipema.org](http://www.ipema.org). In the interest of playground safety, IPEMA provides a Third Party Certification Service which validates compliance.

## 2010 ADA Standards for Accessible Design

The lay-out was also designed to meet the 2010 Standards published 15-Sep-2010, by the Department of Justice when installed over a properly maintained surfacing material that is in compliance with ASTM F1951 "Accessibility of Surface Systems Under and Around Playground Equipment" as well as ASTM F1292, "Impact Attenuation of Surfacing Materials Within the Use Zone of Playground Equipment", appropriate for the fall height of the structure.

## Installation Times

Installation times are based on one experienced installer. A crew of three experienced individuals can perform the installation within the given time, each member working 1/3 of the given hours. [Eg. Installation Time = 30 hours. For a crew of three, each member will work 10 hours on the installation for a total of 30 hours on the project.]

## Carbon Footprint

The CO2e (carbon footprint given in Kilograms and Metric Tons) listed above is a measure of the environmental impact this play structure represents from harvesting raw materials to the time it leaves our shipping dock. Playworld Systems nurtures a total corporate culture that is focused on eliminating carbon producing processes and products, reducing our use of precious raw materials, reusing materials whenever possible and recycling materials at every opportunity. Playworld Systems elected to adopt the Publicly Available Specification; PAS 2050 as published by the British Standards Institute and sponsored by Defra and the Carbon Trust. The PAS 2050 has gained international acceptance as a specification that measures the greenhouse gas emissions in services and goods throughout their entire life cycle.

## Pre-Consumer Recycle Content

A measurement, in pounds, that qualifies the amount of material that was captured as waste and diverted from landfill during an initial manufacturing process and is being redirected to a separate manufacturing process to become a different product. E.g. 100% of our Aluminum Tubing is made from captured waste material during the manufacturing process of extruded Aluminum products such as rods, flat bars and H-channels.

## Post-Consumer Recycle Content

A measurement, in pounds, that qualifies the amount of material that was once another product that has completed its lifecycle and has been diverted from a landfill as a solid waste through recycling and is now being used in a Playworld Systems' product. E.g. \*\*20% to 40% of the steel in our steel tubing and sheet steel have been diverted from landfills. Automobiles are scrapped and recyclable steel is purchased by the steel mill that produces our raw product.

\*\* The amount of Post-Consumer recycled steel fluctuates daily based on the availability of the recycled steel.







COLOR PALETTE:

MANUFACTURERS:

PROJECT:

FAMILY SERVICES - 2-5 AREA EAST

MURRIETA, CA

DESIGNED BY:

JONATHAN BOURBONNAIS

DECEMBER 30, 2024

DRAWING# C24422CHR1

PROJECT# 24006303

DESIGNED FOR:

AGES

2-5

since 1979

dave bang

associates inc.

park+playground outfitters







COLOR PALETTE:



MANUFACTURERS:



PROJECT:

FAMILY SERVICES - 2-5 AREA EAST  
MURRIETA, CA

DESIGNED BY:

JONATHAN BOURBONNAIS  
DECEMBER 30, 2024  
DRAWING# C24422CHR1  
PROJECT# 24006303

DESIGNED FOR:

AGES  
2-5

since 1979  
**dave bang**  
associates inc.  
▶ park+playground outfitters







COLOR PALETTE:



MANUFACTURERS:



PROJECT:

FAMILY SERVICES - 2-5 AREA EAST  
MURRIETA, CA

DESIGNED BY:

JONATHAN BOURBONNAIS  
DECEMBER 30, 2024  
DRAWING# C24422CHR1  
PROJECT# 24006303

DESIGNED FOR:

AGES  
2-5

since 1979  
**dave bang**  
associates inc.  
park+playground outfitters







COLOR PALETTE:

MANUFACTURERS:

PERCUSSIPLY  
PLAYWORLD  
cre8play

PROJECT:

FAMILY SERVICES - 2-5 AREA EAST

MURRIETA, CA

DESIGNED BY:  
JONATHAN BOURBONNAIS  
DECEMBER 30, 2024  
DRAWING# C24422CHR1  
PROJECT# 24006303

DESIGNED FOR:

AGES  
2-5

since 1979  
dave bang  
associates inc.  
park+playground outfitters







COLOR PALETTE:



MANUFACTURERS:



PROJECT:

FAMILY SERVICES - 2-5 AREA EAST  
MURRIETA, CA

DESIGNED BY:

JONATHAN BOURBONNAIS  
DECEMBER 30, 2024  
DRAWING# C24422CHR1  
PROJECT# 24006303

DESIGNED FOR:

AGES  
2-5

since 1979  
**dave bang**  
associates inc.  
park+playground outfitters







COLOR PALETTE:

MANUFACTURERS:

PROJECT:

FAMILY SERVICES - 2-5 AREA EAST

MURRIETA, CA

DESIGNED BY:

JONATHAN BOURBONNAIS

DECEMBER 30, 2024

DRAWING# C24422CHR1

PROJECT# 24006303

DESIGNED FOR:

AGES

2-5

since 1979

dave bang

associates inc.

park+playground outfitters







COLOR PALETTE:

MANUFACTURERS:

PROJECT:

FAMILY SERVICES - 2-5 AREA EAST

MURRIETA, CA

DESIGNED BY:

JONATHAN BOURBONNAIS

DECEMBER 30, 2024

DRAWING# C24422CHR1

PROJECT# 24006303

DESIGNED FOR:

AGES

2-5

since 1979

dave bang

associates inc.

park+playground outfitters





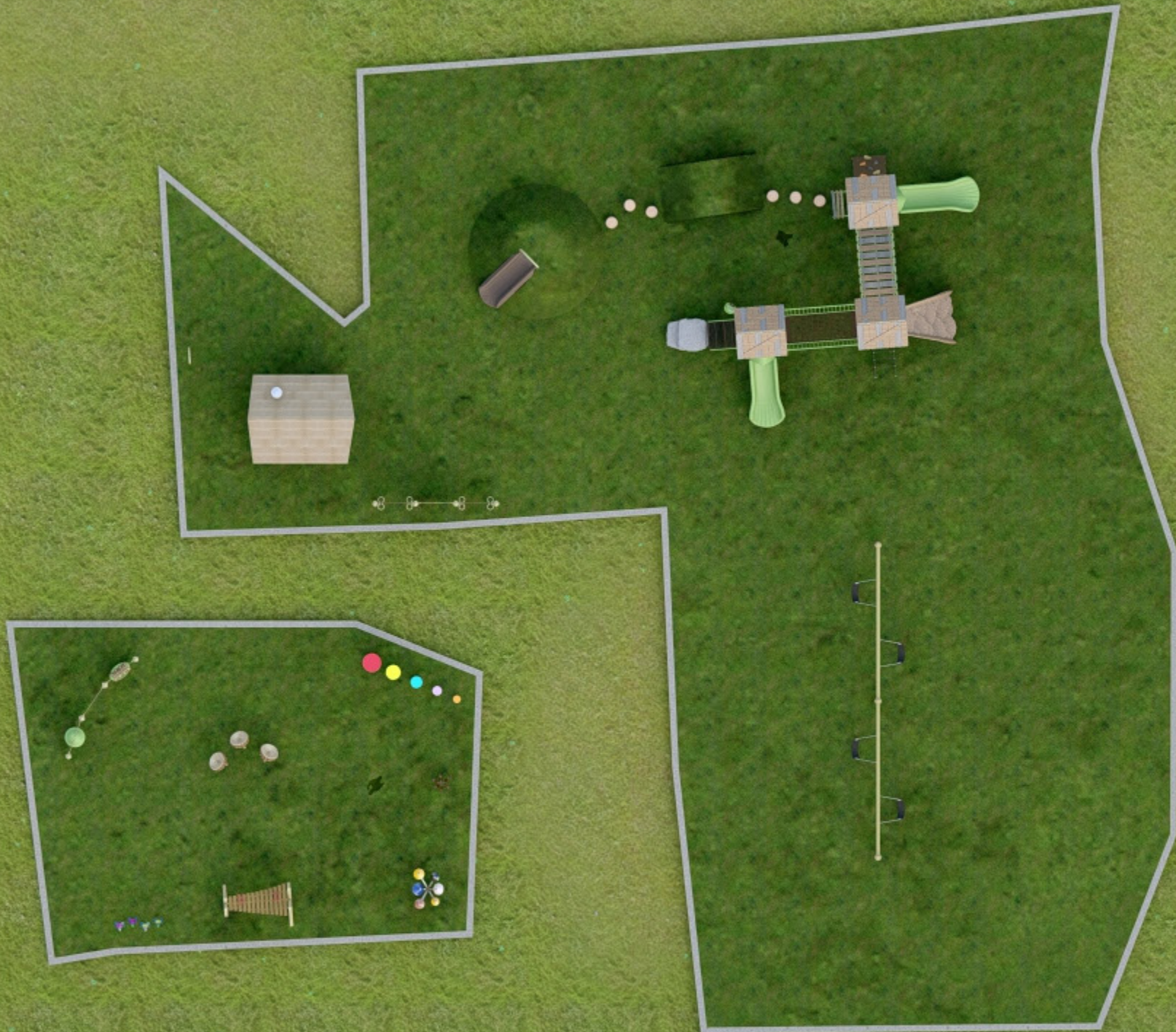

## SELECTED COLORS

POST: SAND

COMPONENT 1: LIME

COMPONENT 2: N/A

ROTOMOLDED PLASTIC 1: LIME

ROTOMOLDED PLASTIC 2: N/A

ROTOMOLDED PLASTIC 3: N/A

SHEET PLASTIC 1: DARK BROWN

SHEET PLASTIC 2: N/A

2-TONE PLASTIC: DARK BROWN/SAND

ROPE: N/A

ECO-ARMOR: BROWN

## MODIFIED COLORS LISTED BELOW

ROCK CLIMBER: BROWNSTONE

COLOR PALETTE:



MANUFACTURERS:



PROJECT:

FAMILY SERVICES - 2-5 AREA EAST  
MURRIETA, CA

DESIGNED BY:

JONATHAN BOURBONNAIS  
DECEMBER 30, 2024  
DRAWING# C24422CHR1  
PROJECT# 24006303

DESIGNED FOR:

AGES  
2-5

since 1979  
**dave bang**  
associates inc.  
park+playground outfitters





TOTAL ELEVATED PLAY COMPONENTS: 8  
TOTAL ELEVATED PLAY COMPONENTS ACCESSIBLE BY RAMP: 0  
TOTAL ELEVATED PLAY COMPONENTS ACCESSIBLE BY TRANSFER: 7  
TOTAL ACCESSIBLE GROUND LEVEL COMPONENTS SHOWN: 10  
TOTAL ACCESSIBLE GROUND LEVEL COMPONENTS OF DIFFERENT TYPES: 5

REQUIRED: 0
REQUIRED: 4
REQUIRED: 3
REQUIRED: 3

\*APPLICABLE ONLY WITH ADA COMPLIANT SURFACING.

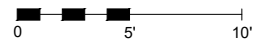
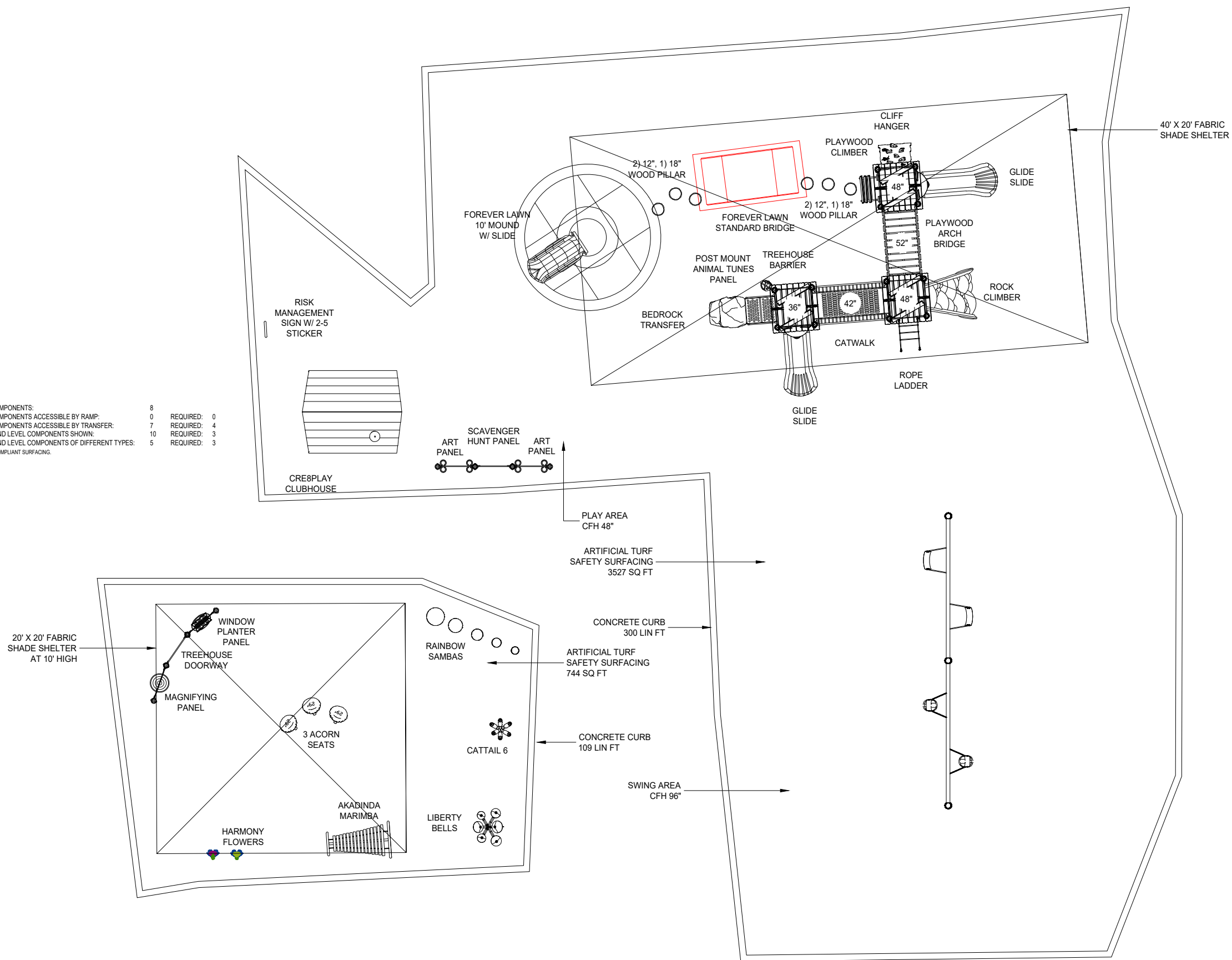

PLAY STRUCTURE AND LAYOUT OF THE COMPONENTS CONFORM TO  
ASTM F1487-21 AND CPSC #325 GUIDELINES AND CCR TITLE 22,  
DIVISION 4 CHAPTER 22.  
CRITICAL FALL HEIGHT OF OVERALL PLAY AREA: 96"

PROJECT  
**FAMILY SERVICES - 2-5 AREA EAST**  
MURRIETA, CA

DESIGNED BY:  
JONATHAN BOURBONNAIS  
DECEMBER 27, 2024  
DRAWING # **C24422CHR1**  
PROJECT # **24006303**

DESIGNED FOR  
**AGES**  
**2-5**

since 1979  
**dave bang**  
associates inc.  
park+playground outfitters

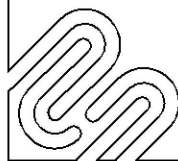



# Family Services

Design Number: C24422CHR1 - Bill Of Material

Ref. No.	Part No.	Description	Quantity
<b>Posts</b>			
1	ZZCH0217	3.5in OD x 156in SWAGED STEEL POST	12
2	ZZCH0356	3.50in x 88in STEEL POST w/CAP	8
<b>Decks &amp; Kick Plates</b>			
3	ZZCH0676	CH PLAYWOOD SQUARE DECK	3
4	ZZCH2805	ENTRY SUPPORT BRACKET	2
<b>Slides</b>			
5	ZZCH3126	GLIDE SLIDE (48in DECK)	1
6	ZZCH3127	GLIDE SLIDE (36in DECK)	1
<b>Activity Panels</b>			
7	ZZCH4379	ART PANEL (GROUND LEVEL)	2
8	ZZCH4547	SCAVENGER HUNT (GROUND LEVEL)	1
9	ZZCH4626	WINDOW PLANTER PANEL	1
10	ZZCH4627	MAGNIFYING PLAY PANEL	1
11	ZZCH4638	NATURE SOUNDS POST MOUNT PANEL	1
12	ZZCH4639	TREE HOUSE DOORWAY (GROUND LEVEL)	1
13	ZZCH4647	TREE HOUSE BARRIER	1
<b>Bridges</b>			
14	ZZCH6958	6ft PLAYWOOD ARCH BRIDGE	1
<b>Climbers</b>			
15	ZZCH6987	CLIFF HANGER (INCLINED) (48in DECK)	1
<b>Bridges</b>			
16	ZZCH7085	6ft CATWALK	1
<b>Climbers</b>			
17	ZZCH7237	ROPE LADDER- 48in DECK	1
18	ZZCH7439	ROCK CLIMBER (48in DECK)	1
19	ZZCH8256	48in PLAYWOOD CLIMBER	1
<b>ADA Items</b>			
20	ZZCH8818	BEDROCK TRANSFER- 36in BARRIER	1
<b>Roofs &amp; Arches</b>			
21	ZZCH9606	PLAYWOOD SINGLE PEAK ROOF	3
<b>Balance</b>			
22	ZZUN8801	12in WOOD PILLAR	4
23	ZZUN8802	18in WOOD PILLAR	2



## Family Services

Design Number: C24422CHR1 - Compliance and Technical Data

Reference Document: ASTM F1487

Ref. No.	Part No.	Qty.	Description	Unit ASTM Status	Total Weight (lbs)	Pre- Consumer Recycled Content (lbs)	Post- Consumer Content (lbs)	CO2e Footprint (kgs)	Users	Install Hours	Concrete (Yds3)	Active Play Events
1	ZZCH0217	12	3.5in OD x 156in SWAGED STEEL POST	Certified	945.72			762	0	6.00	1.50	0
2	ZZCH0356	8	3.50in x 88in STEEL POST w/CAP	Certified	237.68			316	0	8.00	1.04	0
3	ZZCH0676	3	CH PLAYWOOD SQUARE DECK	Certified	336.39			549	9	3.00	0.00	0
4	ZZCH2805	2	ENTRY SUPPORT BRACKET	Certified	24.88			115	0	1.00	0.00	0
5	ZZCH3126	1	GLIDE SLIDE (48in DECK)	Certified	119.73			492	2	1.50	0.03	1
6	ZZCH3127	1	GLIDE SLIDE (36in DECK)	Certified	99.73			374	2	1.50	0.03	1
7	ZZCH4379	2	ART PANEL (GROUND LEVEL)	Certified	41.80			501	0	2.00	0.00	0
8	ZZCH4547	1	SCAVENGER HUNT (GROUND LEVEL)	Certified	42.88			512	3	2.00	0.00	1
9	ZZCH4626	1	WINDOW PLANTER PANEL	Certified	42.83			387	2	0.50	0.00	1
10	ZZCH4627	1	MAGNIFYING PLAY PANEL	Certified	34.66			426	2	0.50	0.00	1
11	ZZCH4638	1	NATURE SOUNDS POST MOUNT PANEL	Certified	30.03			738	1	0.50	0.00	1
12	ZZCH4639	1	TREE HOUSE DOORWAY (GROUND LEVEL)	Certified	22.42			283	2	0.50	0.00	1
13	ZZCH4647	1	TREE HOUSE BARRIER	Certified	42.82			300	0	0.50	0.00	0
14	ZZCH6958	1	6ft PLAYWOOD ARCH BRIDGE	Certified	327.89			434	3	2.50	0.00	1
15	ZZCH6987	1	CLIFF HANGER (INCLINED) (48in DECK)	Certified	107.60			447	1	2.00	0.06	1
16	ZZCH7085	1	6ft CATWALK	Certified	235.56			433	2	4.00	0.00	1
17	ZZCH7237	1	ROPE LADDER- 48in DECK	Certified	51.79			345	1	2.00	0.06	1
18	ZZCH7439	1	ROCK CLIMBER (48in DECK)	Certified	136.38			555	3	2.00	0.03	1
19	ZZCH8256	1	48in PLAYWOOD CLIMBER	Certified	69.88			125	2	2.00	0.06	1
20	ZZCH8818	1	BEDROCK TRANSFER- 36in BARRIER	Certified	831.66			2,775	2	3.50	0.22	1
21	ZZCH9606	3	PLAYWOOD SINGLE PEAK ROOF	Certified	549.57			641	0	9.00	0.00	0
22	ZZUN8801	4	12in WOOD PILLAR	Certified	563.24			2,363	4	6.00	0.24	4
23	ZZUN8802	2	18in WOOD PILLAR	Certified	321.78			1,181	2	3.00	0.12	2
<b>Totals:</b>					<b>5,216.92</b>	<b>705</b>	<b>778</b>	<b>15,055</b>	<b>43</b>	<b>63.50</b>	<b>3.39</b>	<b>20</b>
					<b>0 Kg</b>	<b>0 Kg</b>	<b>0 Kg</b>	<b>0 Metric Tons</b>	<b>0 m3</b>			





# Family Services

Design Number: C24422CHR1 - Compliance and Technical Data

Reference Document: ASTM F1487

Ref.	Unit	Total	Pre-Consumer	Post-Consumer	CO2e		Install	Concrete	Active
No.	ASTM	Weight	Recycled	Content	Footprint	Users	Hours	(Yds3)	Play
Part No.	Status	(lbs)	(lbs)	(lbs)	(kgs)				Events
Qty.	Description								

## ASTM F1487

The lay-out for this custom playscape, design number C24422CHR1, has been configured to meet the requirements of the ASTM F1487 standard. In addition, each of the above components listed as "Certified" have been tested and are IPEMA certified. Components listed as "Not Applicable" do not fall within the scope of the ASTM F1487 standard and have not been tested. IPEMA certification can be verified on the IPEMA website, [www.ipema.org](http://www.ipema.org). In the interest of playground safety, IPEMA provides a Third Party Certification Service which validates compliance.

## 2010 ADA Standards for Accessible Design

The lay-out was also designed to meet the 2010 Standards published 15-Sep-2010, by the Department of Justice when installed over a properly maintained surfacing material that is in compliance with ASTM F1951 "Accessibility of Surface Systems Under and Around Playground Equipment" as well as ASTM F1292, "Impact Attenuation of Surfacing Materials Within the Use Zone of Playground Equipment", appropriate for the fall height of the structure.

## Installation Times

Installation times are based on one experienced installer. A crew of three experienced individuals can perform the installation within the given time, each member working 1/3 of the given hours. [Eg. Installation Time = 30 hours. For a crew of three, each member will work 10 hours on the installation for a total of 30 hours on the project.]

## Carbon Footprint

The CO2e (carbon footprint given in Kilograms and Metric Tons) listed above is a measure of the environmental impact this play structure represents from harvesting raw materials to the time it leaves our shipping dock. Playworld Systems nurtures a total corporate culture that is focused on eliminating carbon producing processes and products, reducing our use of precious raw materials, reusing materials whenever possible and recycling materials at every opportunity. Playworld Systems elected to adopt the Publicly Available Specification; PAS 2050 as published by the British Standards Institute and sponsored by Defra and the Carbon Trust. The PAS 2050 has gained international acceptance as a specification that measures the greenhouse gas emissions in services and goods throughout their entire life cycle.

## Pre-Consumer Recycle Content

A measurement, in pounds, that qualifies the amount of material that was captured as waste and diverted from landfill during an initial manufacturing process and is being redirected to a separate manufacturing process to become a different product. E.g. 100% of our Aluminum Tubing is made from captured waste material during the manufacturing process of extruded Aluminum products such as rods, flat bars and H-channels.

## Post-Consumer Recycle Content

A measurement, in pounds, that qualifies the amount of material that was once another product that has completed its lifecycle and has been diverted from a landfill as a solid waste through recycling and is now being used in a Playworld Systems' product. E.g. \*\*20% to 40% of the steel in our steel tubing and sheet steel have been diverted from landfills. Automobiles are scrapped and recyclable steel is purchased by the steel mill that produces our raw product.

\*\* The amount of Post-Consumer recycled steel fluctuates daily based on the availability of the recycled steel.

